

Soils Map

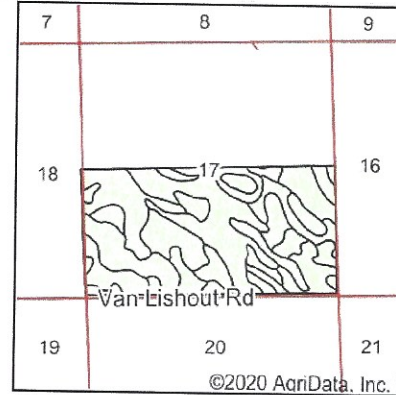
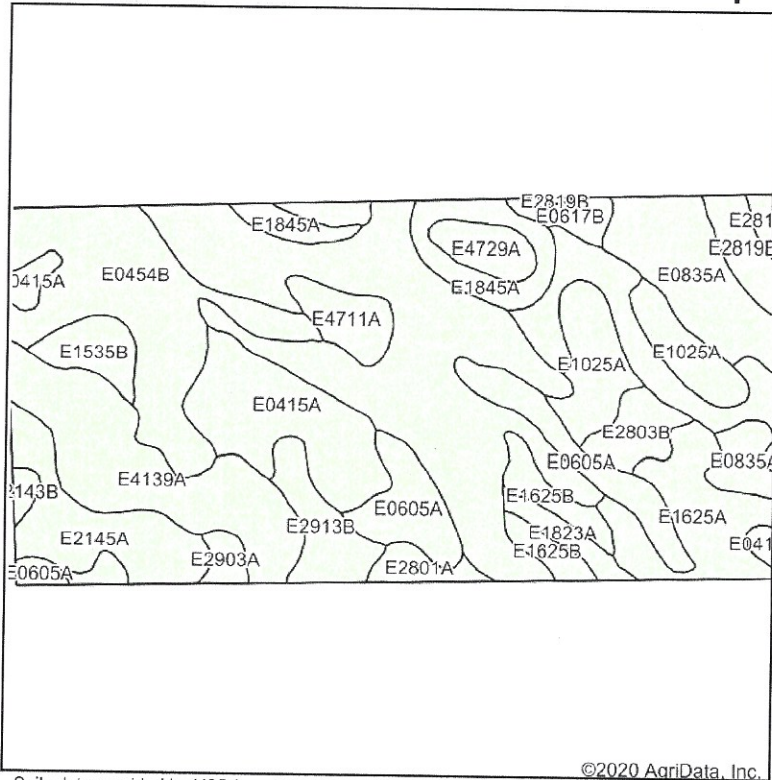

State: **North Dakota**
 County: **Hettinger**
 Location: **17-134N-92W**
 Township: **Beery**
 Acres: **318.48**
 Date: **8/12/2020**

BITZREALTY

Maps Provided By

 CUSTOMIZED ONLINE MAPPING
 © AgriData, Inc. 2020 www.AgridataInc.com

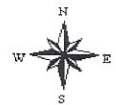

Soils data provided by USDA and NRCS.

©2020 AgriData, Inc.

Area Symbol: ND041, Soil Area Version: 19

Code	Soil Description	Acres	Percent of field	Non-Irr Class *c	Productivity Index	*n NCCPI Soybeans
E1535B	Yegen-Parshall fine sandy loams, 0 to 6 percent slopes	66.53	20.9%	IIIe	71	38
E0454B	Daglum-Rhoades complex, 0 to 6 percent slopes	33.82	10.6%	IVs	35	21
E0605A	Belfield-Grail clay loams, 0 to 2 percent slopes	33.73	10.6%	IIIs	82	31
E4139A	Korchea-Fluvaquents complex, channeled, 0 to 2 percent slopes, frequently flooded	27.86	8.7%	VIW	43	14
E0415A	Belfield-Daglum complex, 0 to 2 percent slopes	23.57	7.4%	IIIs	60	28
E0835A	Savage-Grail silty clay loams, 0 to 2 percent slopes	20.72	6.5%	IIc	90	35
E1625A	Vebar-Parshall fine sandy loams, 0 to 3 percent slopes	15.93	5.0%	IIIe	66	29
E1025A	Regent-Savage silty clay loams, 0 to 3 percent slopes	15.78	5.0%	IIIs	84	25
E2145A	Shambo loam, 0 to 2 percent slopes	15.67	4.9%	IIc	87	44
E1845A	Peta loam, 0 to 2 percent slopes	11.13	3.5%	IIc	90	42
E2913B	Chama-Sen-Cabba silt loams, 3 to 6 percent slopes	8.03	2.5%	IIIe	67	31
E1625B	Vebar-Parshall fine sandy loams, 3 to 6 percent slopes	6.98	2.2%	IIIe	63	28
E4729A	Heil silty clay loam, 0 to 1 percent slopes	6.65	2.1%	VIIs	35	12
E4711A	Dimmick silty clay, 0 to 1 percent slopes	5.72	1.8%	VW	30	6
E2803B	Amor-Shambo loams, 3 to 6 percent slopes	5.66	1.8%	IIe	76	31
E2819B	Reeder-Farnuf loams, 3 to 6 percent slopes	4.94	1.6%	IIe	78	32
E2903A	Chama-Sen silt loams, 0 to 3 percent slopes	3.49	1.1%	IIIe	72	32
E1823A	Parshall fine sandy loam, 0 to 2 percent slopes	3.40	1.1%	IIIe	71	35
E0617B	Belfield-Savage-Daglum complex, 2 to 6 percent slopes	3.24	1.0%	IIe	65	29
E2801A	Amor-Arnegard loams, 0 to 3 percent slopes	3.16	1.0%	IIIs	81	31
E2819A	Reeder-Farnuf loams, 0 to 3 percent slopes	1.25	0.4%	IIIs	84	33
E2143B	Felor loam, terrace, 0 to 6 percent slopes	1.22	0.4%	IIe	83	37
Weighted Average					66.7	*n 29.7

*n: The aggregation method is "Weighted Average using all components"

*c: Using Capabilities Class Dominant Condition Aggregation Method

Soils data provided by USDA and NRCS.